

PRODUCT STANDARDS

- We are either members of or affiliated with **N.A.A.M.M.** - National Association of Architectural Metals Manufacturers, **A.W.I.** - Architectural Woodwork Institute, **N.W.W.D.A.** - National Wood Windows & Door Association, **D.H.I.** - Door & Hardware Institute, **S.D.I.** - Steel Door Institute. Our products are manufactured and designed to incorporate their specifications.
 - Frame, door & hardware sizing, preparations, hardware locations, gauges & series specifications are B.M.I. standard specifications, unless indicated otherwise.
 - Unless specifically noted, we exclude all B.M.I. options, prep. for surface or concealed hardware, erection, channel or structural frames, hardware applications, field measurements, crating, drilling & tapping for hardware, any and all field work or other item, specification, product or provision not standard to our line.
 - In order to provide our customers with the finest products manufactured in the most up-to-date manner, BMI reserves the right to make design changes or specific product construction changes without notice. All products may vary due to mfg. tolerances.
- Bildisco Manufacturing is approved and licensed by WH - Warnock Hershey for hollow metal doors and frames and wood doors.

INDUSTRY GRADE GUIDE

Frames, doors and hardware fall into 5 groups (i.e. grades). This guide will help you choose the right grade of material at the most economical price.

The grades of material are based on "Frequency of use & performance characteristics." While not over specifying (spending too much), be careful to avoid under specifying which later leads to large outlays for maintenance & replacement costs.

INDUSTRY GRADE GUIDE					
GRADE	1	2	3	4	5
DUTY	EXTRA HEAVY	HEAVY	STANDARD	MODERATE	LIGHT
THICKNESS	1 3/4"	1 3/4"	1 3/4"	1 3/4", 3/8"	1 3/8"
FREQUENCY OF USE (CYCLES)	750,000	500,000	250,000	100,000	50,000
QUALITY PERFORMANCE (STRESS)	BEST	BETTER	GOOD	FAIR	UTILITY
BILDISCO PRODUCTS (GRADES ARE ALSO SHOWN ON ALL DETAIL SHEETS)					
BILDISCO PRODUCT	FORTISSIMO	PRIMA QUALITA	SHTARK	SILNY	ECONOMICA
DERIVED FROM	ITALIAN	ITALIAN	YIDDISH	POLISH	SPANISH
MEANING	STRONGEST OF ALL	FIRST QUALITY, BEST	STRONG	FORMIDABLE	ECONOMICAL VALUE
FRAMES HOLLOW METAL/STEEL	16 GA.	18 GA.	20 GA.	22 GA 1 3/8	WOOD
DOORS HOLLOW METAL/STEEL	18 GA.	20 GA.	24 GA. ST. EDGE	24 GA. WD/EDGE	not made
DOORS WOOD-FLUSH OR STYLE & RAIL	not made	1-3/4 style & rail 1-3/4 solid core flush	1-3/4 hollow core flush	1-3/8 style & rail 1-3/8 solid core flush	1 3/8 hollow core flush
UNITS & PREHUNG	BY - PRODUCTS OF DOOR AND/OR FRAME				
HARDWARE	WE DO NOT MANUFACTURE OR FABRICATE, BUT ALL GRADES OF OPERABLE HARDWARE ARE SHOWN ON DETAIL SHEETS				

SWING GUIDE

L	S	R	PU	PA	PR
Left Hand	Slab	Right Hand	Unusual		Standard
Active	-	Active	R - Inactive L - Active	R - Active L - Active	R - Active L - Inactive
Hinge & Latch Prep	No Hdwe. Preps	Hinge & Latch Prep	Hinge, Latch, Strike Prep Top & Bottom FB Prep	Hinge Preps Only	Hinge, Latch, Strike Prep Top & Bottom FB Prep



or

RHH
Right Hand
Reverse

or

LHH
Left Hand
Reverse

Only Important in Reference to

Mortise Lock

Rev = Reversible Swing 1 3/4 Door

BILDISCO MFG., INC.

BASIC FIRE DOOR REQUIREMENTS S.D.I. 118-76

INTRODUCTION

- Fire doors and their hardware have always been a mystifying subject to those in the construction field. Most of the confusion is created by the multitude of code authorizes governing the use of fire doors. To comprehend the entire industry program of fire doors, frames and related hardware is almost an impossibility but basic rules do exist which tend to simplify the labeled door opening.
- Fire doors must serve four main purposes: 1) to serve as a regular door at all times; 2) to provide ready egress from a fire area during a fire; 3) to keep the fire from spreading throughout the building or an adjacent building; and 4) to protect life and property by reducing smoke hazards.

Description	Illustration	Class	Frame, Door Rating	Doors Max/Glass	Sidelights, Borrowed Lights, Transoms with Glass	Sidelights, Transoms with Panels
Door opening in walls separating buildings or dividing a single building into fire areas		A	3 hour	None	No	No
Door openings which enclose vertical communication through buildings. Example: stairwells, elevator shafts. Also mechanical equipment rooms such as boiler rooms, etc.		B	1½ hour	100 sq. in.	No	Yes
Door openings in exterior walls which are subject to severe fire exposure from the outside of the building.		B/A	1½ hour	None	No	No
Door openings from corridors and room partitions.		B C	1 Hour 3/4 Hour	100 sq. in. 1296 sq. in.	No Yes	Yes Yes
Door openings which separate building into areas providing smoke protection within the corridors.		C	1/3 hour	1296 sq. in.	Yes	Yes

THE FIVE BASIC REQUIREMENTS FOR A FIRE RATED OPENING

THE FIVE BASIC REQUIREMENTS FOR A FIRE RATED OPENING

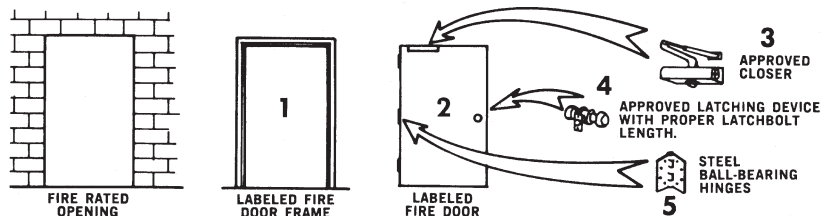

SUGGESTED PROCEDURE FOR THE SELECTION OF FIRE DOORS & HARDWARE

- Determine the appropriate building code.
- Check and fulfill the fire insurance company's requirements for the specific buildings.
- Basic Fire Door Requirements - Use this check list.
 - A fire door must have a label attached.
 - A fire door frame must have a label attached.
 - A fire door must be self-latching.
 - Door closers are required on all fire doors.
 - If a fire door is an automatic closing door, it must be equipped with a heat responsive device or a smoke detection device.
 - A fire door must be free of any obstructions which should prevent the door operating properly, i.e., wedge door stops, chains, hookbacks, etc.
 - Only listed fire door hardware shall be used.
 - A fire door must have steel hinges, and all hinges must be of the ball bearing type except spring type hinges.
 - Doors swing in pairs requiring astragals shall have at least one overlapping astragal. Where astragals are prohibited by code provide 1-1/2 hour fire rated units without astragals.
- Fire doors with glass lights:
 - The glass frame and glazing bead must be steel.
 - The glass must be 1/4" thick wire glass.
- Fire doors with fusible link louvers:
 - Only label louvers can be used.
 - Louvers can be furnished in 1-3/4" thick doors with a 1-1/2 hour B label or a 3/4 hour C label (no louver and glass light combination are permitted).
 - Maximum door size with louver is 4/0 x 8/0 single and 8/0 x 7/2 in pairs.
 - Maximum louver size is 24" x 24"
 - Louvers are not permitted to be installed indoors with Fire Exit Hardware or in stairwells.
- For maximum fire protection - Standard number 80 of the National Fire Protection should be used for an installation guide.
- Purchase doors from a recognized responsible manufacturer whose fire doors and frames are produced to conform to Fire Door Procedures.

BILDISCO MFG. INC. IS APPROVED AND LICENSED BY WARNOCK HERSHEY FOR DOOR & FRAME LABELLING

STAINLESS STEEL DOORS & FRAMES

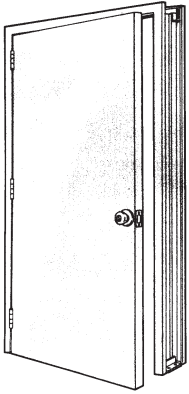

Nothing surpasses the performance of Stainless Steel when the effects of a corrosive atmosphere must be dealt with – or a highly sanitary environment must be maintained.

- Chemical Plants • Swimming Pools
 - Sewage Treatment Plants • Laboratories
 - Research Facilities • Marine Installations
 - Hospitals • Food and Meat Processing Plants
 - Series HS can be provided with "B" Label
- Type 304 Stainless, with a #4 finish is standard.
Type 316 Stainless, with a #4 finish is also available.

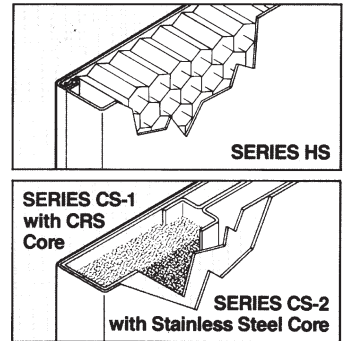

SOUND INSULATING METAL OR WOOD DOOR & FRAME ASSEMBLIES

When sound control between connected spaces is essential, specify BMI Sound Insulating Assemblies for

- Executive Offices, Conference Rooms and Board Rooms • Screening Rooms • Psychiatric Clinics • Libraries
- Broadcast Studios • Rehearsal Rooms • Test Cell Control Rooms • Theater Lobbies • In-Plant Enclosures and other sound sensitive areas.

BMI Sound Insulating Assemblies are furnished as a complete Frame and Door unit, with Perimeter Gasketing and Drop Seal. Acoustical laboratory test reports available on request.

Model No.	F35	F39	F40	F42	F45	F49	F52
Elevation	FLUSH*	FLUSH*	FLUSH*	FLUSH*	FLUSH*	FLUSH*	FLUSH*
STC Rating	35	39	40	42	45	49	52
UL Label	3 HR. "A"			1 ½ HR. "B"		3 HR. "A"	3 HR. "A"

* Glass Lites available for some models – consult BMI.
Wood assemblies also available, STC ratings differ slightly.

Adjustable Sound proof door stops at head and jamb

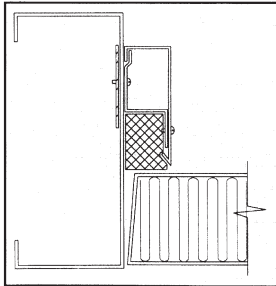

Surface-Mounted Sound Automatic Door Bottom

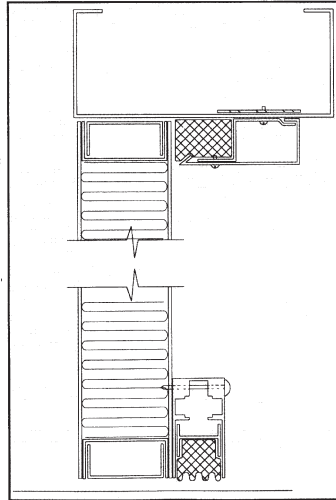

Semi-Mortised Sound Seal

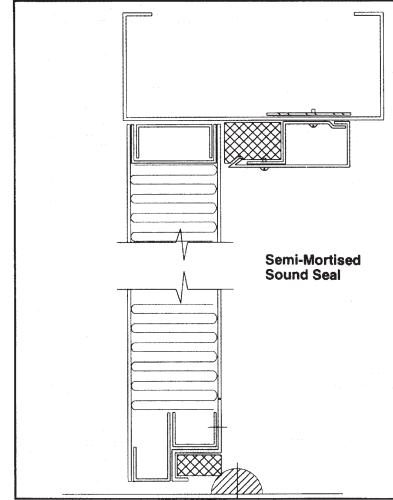

LEAD LINED WOOD OR METAL DOORS & FRAMES



WOOD DOOR

- Lead is either 1/32", 1/16", or 1/8"

METAL DOOR & FRAME

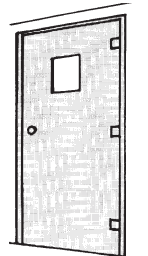

HOLLOW METAL/STEEL FRAMES

F1-FORTISSMO EXTRA HEAVY DUTY - GR. 1

IN STOCK
TO 4/0 WIDTH
TO 9/0 HEIGHT
OR
1-2 DAY EXPRESS
SHOP PRODUCTION

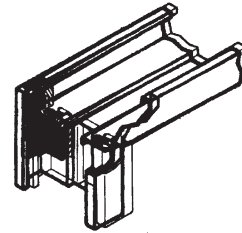
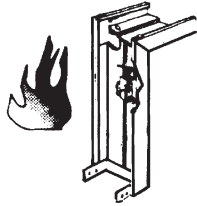

SECTION DIAGRAM

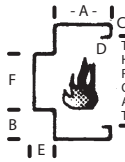

A. Trim 2"
B. Rabbet - 1-15/16"
C. Back Band - 1/2"
D. Double Back Band - 1/4"
E. Stop Depth - 5/8"
F. Stop Varies

F __ P __ Double Rabbet



F __ M __ Mullion

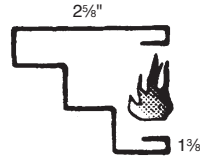

F __ E __ Double Egress



F __ C __ Cased

SERIES & SPECIFICATIONS

FIP	} 6G = 16 Gauge Galvanized	} For 1 1/4 drs
FIC		
FIM		
FIE		
• Zinc Coated Primer (not 6G)		
• Ext. or Int. use		
• Hinge, latch and silencer prep.		
• All frames meet or exceed N.A.A.M.M. specifications		

JAMB THROAT

Standards: 3.6, 4.5, 4.7, 5.5, 6.1, 7.2, 7.6, 11.6, T 76 (to 7 3/4")

- 3.0 to 12.0
- 3 - 5 Day specials - reduce Jamb throat by welding channel

Jamb throat is same as wall size
EX: 3.6 Jt=3 3/4" wall

ASSEMBLY

• KD - Knocked Down • CW - Continuous Welded • PW - Spot Welded

ANCHORS

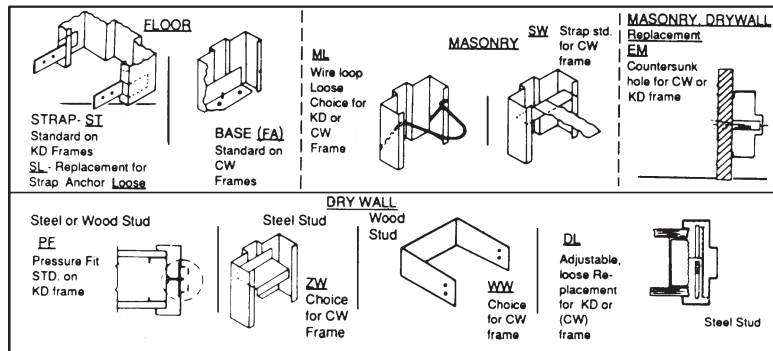

FOR ALUM. FRAMES
SEE PAGE 14

FOR STANDARD HARDWARE PREPARATIONS & ROUGH OPENING SIZES - SEE SPEC. SHEET

ELEVATIONS

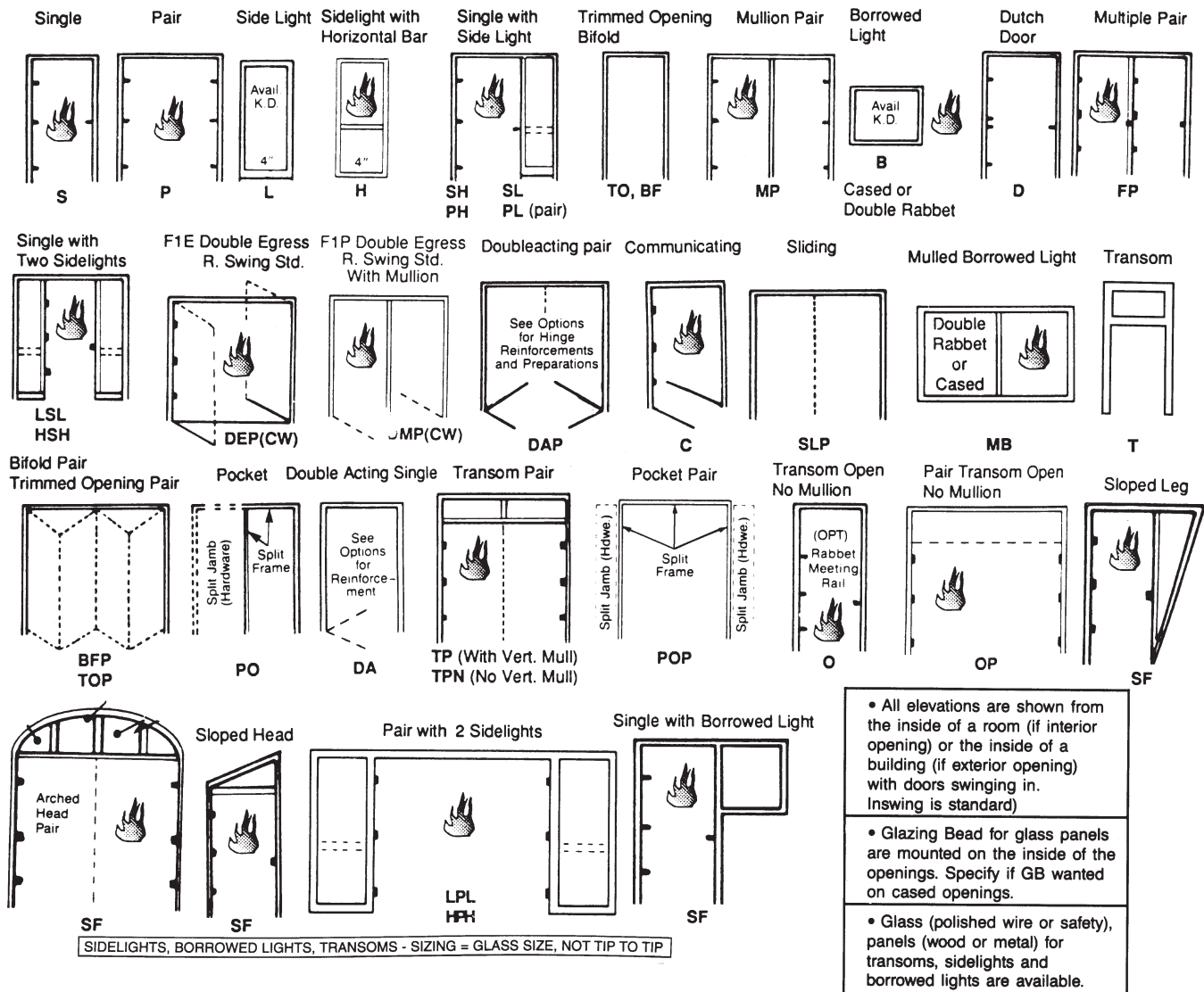

OPTIONS AND VARIATIONS

LABELLED-FIRE RATED

- LA - Labelled - 3 hr. max.
- LB - Labelled - 1 1/2 hr. rated

FINISH AND CORE

- GA - Galvacon Galvanizing
- LL - Lead Lined

TRIM

- 4S - 4" Head (8 Block Layers, on 7/0 H.) single
- 4P - 4" Head (8 Block Layers, on 7/0 H.) pair
- T1 - 1" - 1-7/8" Trim - Ex 1-7/8" = T1.7
- T2 - 2-1/8" - 4" Trim
- T4 - 4-1/8" - 6" Trim

EM
Anchors
Only

MISCELLANEOUS

- FS - Field Splice - Reduces Handling Problems
 - RM - Removable Mullion
 - RT - Removable Transom
 - DA - Increase Width of Frame To Accomodate H.M. Double Acting Doors.
- For Wood Doors, See Bullnose Options & Variations

HARDWARE PREPARATION (For our stock hardware. We do all & any hardware prep. such as pivots, reinforcements, special locks & latches, etc.)

- H5 - 5" Hinge
- AH - Add Hinge
- CH - Close Hinge Location
- HR - Relocate Hinge
- R4 - Reinforce & Tap for 4-1/2" Surface Mount Hinge
- DP - Cylinder Deadlock Strike
- SE - Electric Strike
- BP - No Strike (Panic, Push, Pull)
- SR - Relocate Strike
- AS - Add Strike
- H6 - 6" Hinge (Bommer) - LH or RH

FOR STAINLESS STEEL, SOUND INSULATING & LEAD LINED - SEE PAGE 3

HOLLOW METAL/STEEL DOORS

"FORTISSIMO" EXTRA HEAVY DUTY	"PRIMA QUALITA" HEAVY DUTY	"SHTARK" STANDARD DUTY
GRADE 1	GRADE 2	GRADE 3

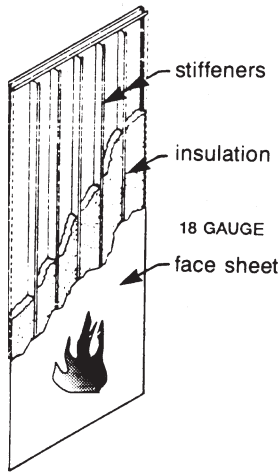

STEEL STIFFENERS
DAH8SR
DAH6SR

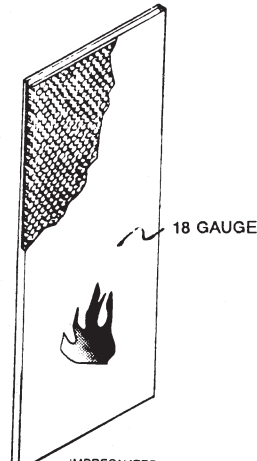

IMPREGNATED
HONEYCOMB
DAH8
DAH8G

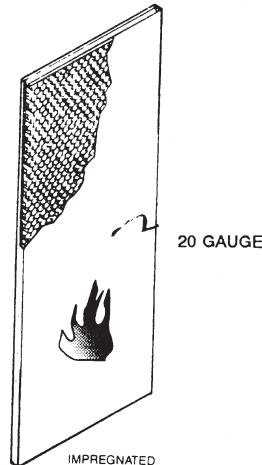

IMPREGNATED
HONEYCOMB
DAHO
DAHOG

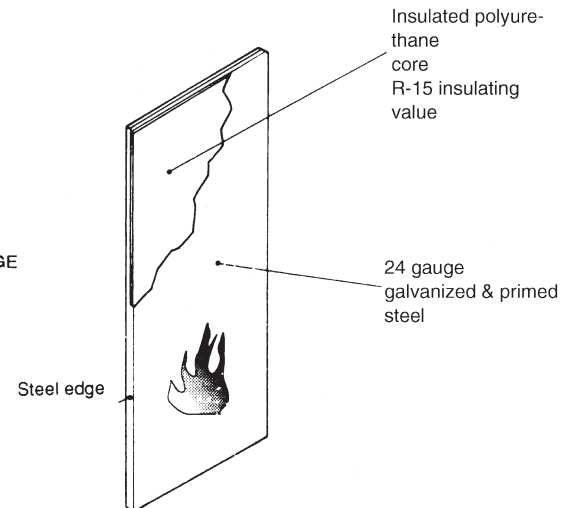

SERIES		SPECIFICATIONS		
TYPE	GAUGE		CORE	GRADE
DAH	•8 = 18	• 1-3/4" Thick	Honeycomb	1
DAH	•6SR = 16 •8SR = 18	• Primed	Steel Ribbed	1
DAH	•0 = 20	• Prefit and Premachined	Honeycomb	2
G (Suffix)	Galvanized	• Lock Seam Edge	Honeycomb	2
		• Doors are Square Edge and Reversible		
		• 3/16" Hinge Reinforcement		
		• L & R are Beveled Edge and Handed		

SERIES		SPECIFICATIONS		
TYPE	GAUGE	MATERIAL		EDGE
DRIL	24	Insulated Steel	• 1-3/4" Thick • Grade 3 • Primed • Prefit and Premachined • Square Edge, Reversible	STEEL
ALL DOORS ARE PREMIUM QUALITY AND MEET OR EXCEED N.A.A.M.M. & OR S.D.I. ASSOCIATION SPECIFICATION				
• Special sweep available (see Hdwe. sect.) • Special latch backset 1" x 2-1/4"				

OPTIONS & VARIATIONS

HARDWARE PREPARATIONS - For our stock hardware only, however we do all and any hardware preparation such as pivots, reinforcements, special locks & latches, etc.

- DS - Deadlock Strike For Inactive Door
- H5 - 5" Hinge (LH or RH)
- AH - Add Hinge
- CH - Close Hinge
- HR - Relocate Hinge
- DP - Cylinder Deadlock
- IS - Strike Only on Inactive Door
- II - STDInactive Door Prep, if door Ordered as Single
- AE - Cut Doors (2) for Pair T Astragal (lab)
- H6 - 6" Hinge (Bommer) - LH or RH

MISCELLANEOUS

- SL - Seamless Edges (2)
 - TC - Flush Top Cap - In Addition to Inverted Cap
 - BC - Flush Bottom Cap - In Addition to Inverted Cap
 - U_ - Undercut Total of 1"
 - A - Active of Pair
 - I - Inactive of Pair
 - DA - Double Acting Doors
- See HM Frames

- ME - Mortise Door Edge
- PE - Panic Exit Only
- PP - Push/Pull
- EE - Panic Exit and Entry
- IV - Interviewer
- IC - Interviewer and Chime
- MA - Mail Slot
- LR - Latch & Cylinder Hole Relocation
- P8 - Thru Holes For Grade 1.5 Lever Lock
- PS - Thru Holes For Other Than Parker Hardware

LABELLED - FIRE RATED

- LB - 1-1/2 Label HM Door
- LA - 3 Hr. HM Door
- LC - 20 Minute Label

FINISH

- GA - Galvacon Galvanizing

FOR STAINLESS STEEL, SOUND INSULATING & LEAD LINED SEE PAGE 3

DOOR ELEVATIONS (DESIGNS)

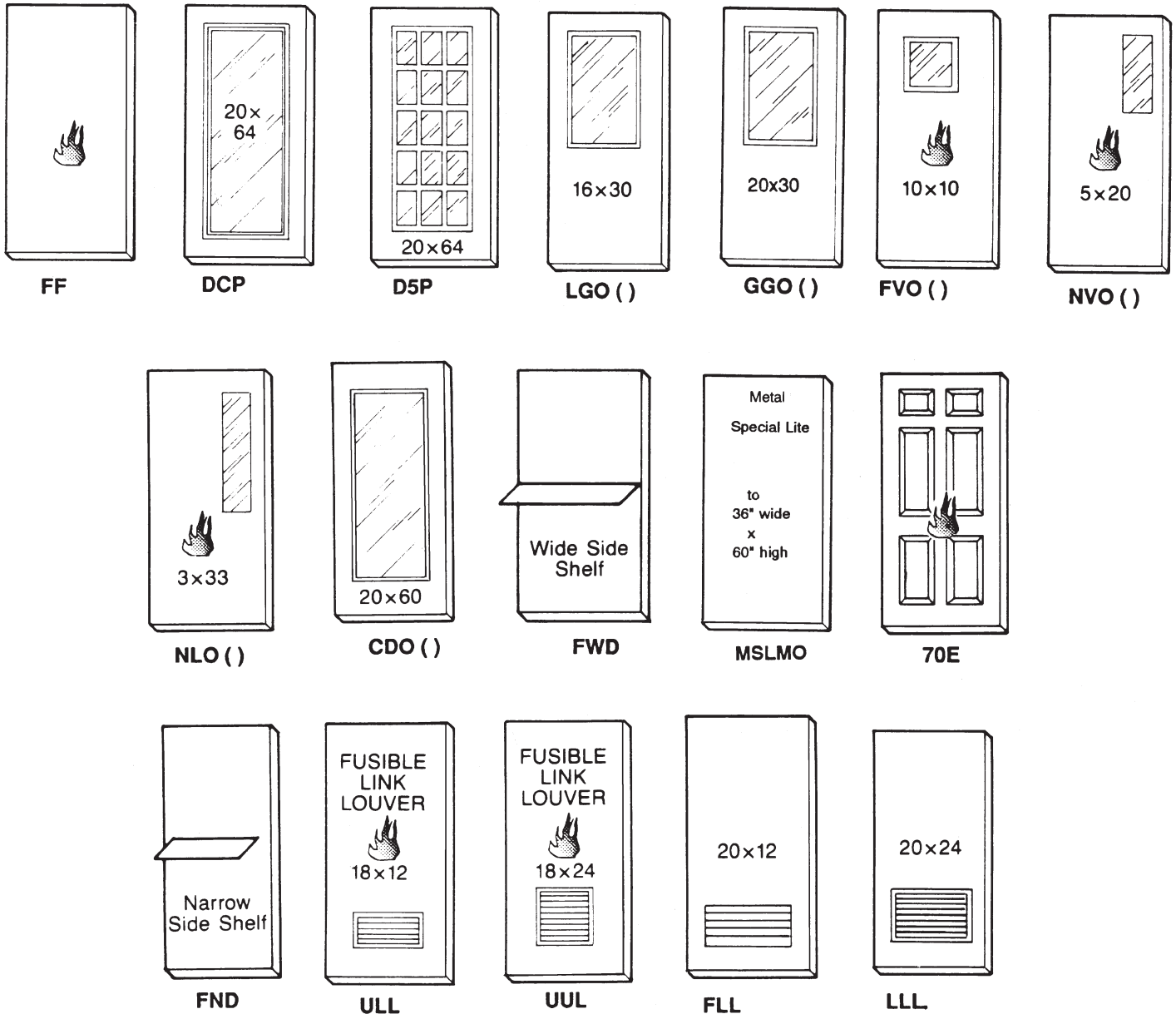

SUFFIX LEGEND (Last Letter)

F - Flush, No Light or Louver

L - Steel Louver

O - Steel Light - Open

P - With 1/4" Polished Wire Glass

S - With 1/4" Safety Glass

WM - Wire Mesh over glass (on opp. side of screw head of light or louver)

P - High Impact Polystyrene Light with Insulated Glass

D - Flush Design Variation

E - Embossed No Lights or Louvers

GENERAL NOTES

- For any other or special designs, consult office.
- All lights and Louvers are Overlap Type on Flush and Embossed Doors.
- Steel Louvers & Lights are Labelled.
- Lights and Louvers are so Mounted that Screw Heads are Exposed on Side Opposite Hinge Pin, or on Prehung Placed on Inside. (These are changeable in field).
- Special size Lights & Louvers are available.
- Plants are mounted on side opposite hinge pin.

**IN STOCK
TO 4/0 WIDTH
TO 9/0 HEIGHT
OR
1-2 DAY EXPRESS
SHOP PRODUCTION**

WOOD DOORS

STYLE & RAIL PANELLED

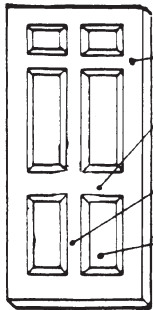

DPA

MANY STYLES
MANY WOOD
SPECIES

- Stiles - upright or vertical members forming the outside pieces
- Rails - horizontal members framing the wood panels and carved wood/glass inserts
- Mullion - vertical framing between the stiles
- Raised Panels - panels set into the door stiles, mullions and rails whose center sections are raised.

FLUSH - SOLID MINERAL CORE

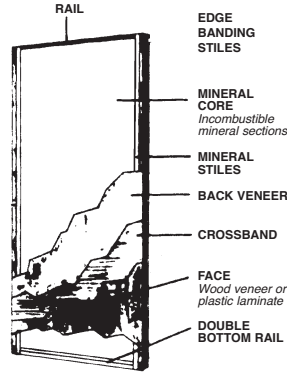

DSM

FLUSH - SOLID PARTICLE CORE

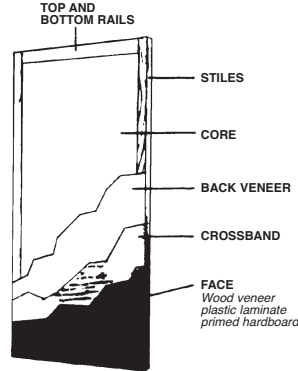

DSA
DSC DS3

FLUSH - HOLLOW HONEYCOMB CORE

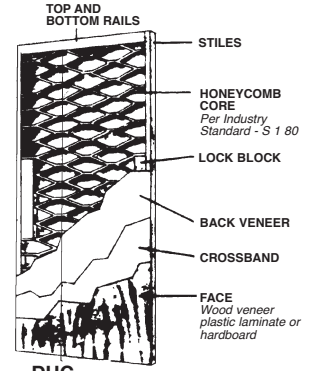

DHC
DH3

- STYLES & RAILS VARY ACCORDING TO STANDARD VERSUS LABELLED DOORS & ASSOCIATION SPECIFICATIONS.
- CONTACT OFFICE FOR INFORMATION ON STORING, FINISHING, HANDLING, INSTALLING & MAINTAINING WOOD DOORS

SERIES & SPECIFICATIONS													
SERIES		DESCRIPTION	THICKNESS	CORE	GRADE	INTERIOR WARRANTY	VENEER						
TYPE	VENEER						GRADE	MATCH	EDGE				
GRADE 1 FORTISSIMO (not made in wood)													
GRADE 2 PRIMA QUALITA													
DPA DSA DSC DSM-6 DSM-9	S E V E N E E R	STYLE & RAIL FLUSH FLUSH FLUSH 60 MIN FLUSH 90 MIN	1-3/4	ARCHITECTURAL-PANELLED ARCH.-PARTICLE CORE COMM.-PARTICLE CORE COMM.-MINERAL CORE COMM.-MINERAL CORE	2	2 YR. LIFE 2 YR. 2 YR. 2 YR.	PREMIUM	BOOK	SAME MATCHING SOFTWOOD HARDWOOD HARDWOOD				
GRADE 3 SHTARK													
DHC		FLUSH		1-3/4		COMM.-HONEYCOMB CORE			3	2 YR.	PREMIUM	BOOK	SOFTWOOD
GRADE 4 SILNY													
DS3	L E G	FLUSH	1-3/8	COMM/RES-PARTICLE CORE	4	1 YR.	GOOD	RANDOM	SOFTWOOD				
GRADE 5 ECONOMICAL													
DH3	E N D	FLUSH, EMBOSSED	1-3/8	RES/HONEYCOMB CORE	5	1 YR.	CUSTOM	RANDOM	SOFTWOOD OR FIBRE				
ALL DOORS MEET OR EXCEED A.W.I. AND/OR N.W.W.D.A. SPECIFICATIONS													

ALL DOORS MEET OR EXCEED A.W.I. AND/OR N.W.W.D.A. SPECIFICATIONS

VENEER LEGEND

- B - ROTARY BIRCH
- O - PLAIN SLICED OAK
- L - LUAN MAHOGANY
- H - PRIMED HARD BOARD (PRIMED WOOD VENEER MAY BE SUBSTITUTED)
- - PLASTIC LAMINATED (WILSON ART) (FORMICA) SEE PL OPTION

OPTIONS & VARIATIONS

HARDWARE PREPARATIONS - For our stock hardware. However, we do all & any hardware preparation such as pivots, any reinforcements, special locks or latches, etc.

- H5 - 5" Hinge
- AH - Add Hinge
- DP - Cylinder Deadlock
- IS - Strike Only on Inactive Door
- II - STDInactive Door Prep if Door Ordered as Single Inactive Door
- AE - Cut Doors (2) for Pair T Astragal (lab)
- ME - Mortise Door Edge
- PE - Panic Exit Only
- PP - Push/Pull
- EE - Panic Exit and Entry
- PU - Pocket Edge Pull
- PB - Oblong Pull 38" on Ctr.
- IV - Interviewer
- IC - Interviewer and Chime
- MA - Mail Slot
- L - Left Hand Standard Hardware Prep.
- R - Right Hand Standard Hardware Prep.
- P8 - Post Thru Holes for Grade 1.5 Lever Lock
- SU - Cond, Stain, Setup & Procurement (1 Time)
- DS - Deadlock Strike for II Door.
- PS - Thru Holes Other than Parker Hardware

LABELLED - FIRE RATED

- L2 - 20 Min. Label, Wood Doors
- 60 Min. Label, Wood Doors
- 90 Min. Label, Wood Doors

Cannot be Machined in Field

FINISH

- PF - Prefinished 2 Coats Clear - F Elev.
- PR - Prime Door
- P3 - Prefinish 3 Coats Clear - F Elev.
- CS - Conditioner (Benwood) & Stain (See Note for Color)
- PT - Pref. Top & Bottom
- P3I - P3 on Door w/Light
- P30 - P3 on Door w/Louver

MISCELLANEOUS

- U - Undercut Total of 1" or 2" (Max on LAB = 1"0)
 - BN - Bull Nose One Edge
 - UR - Undercut 3/4" Total for Sliders
- See Note

VENEER

- A - Active Pair
- I - Inactive Match
- PL - Plastic Laminate (Wilson art) (Formica)

NOTE: Color, order of 5 or more approved sample from customer. 10+ Approved Door from Cust. add 3 additional days to shop time for drying time. Does not include clear finish.

PREFINISHED

PLASTIC LAMINATED

DOOR DESIGNS/ELEVATIONS

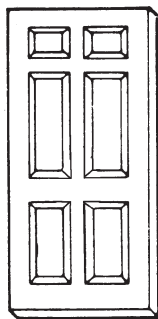

70R

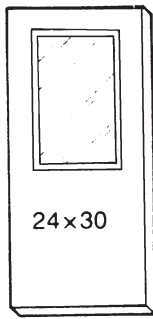

WGS

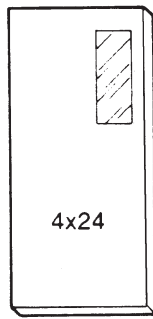

WVS

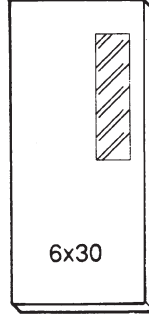

WLS

For Sound Insulating,
Lead Lined &
Stainless Steel
See Page 3

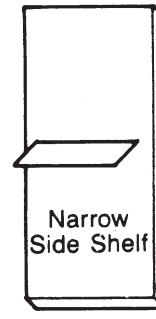

FND

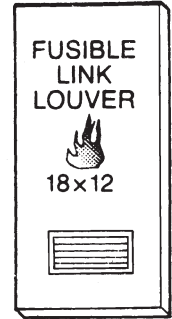

ULL

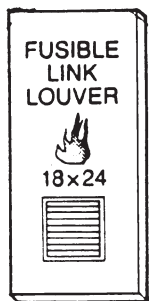

UUL

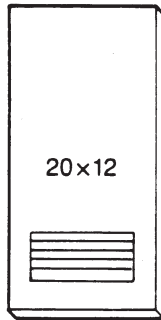

FLL, FLW

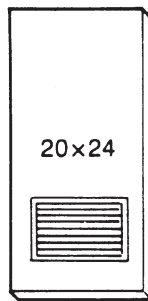

LLL, LLW

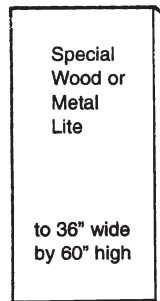

MSLWO, MSLMO



FF

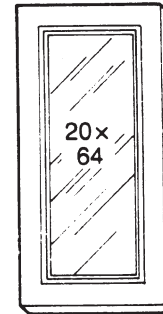

DCP, DCS

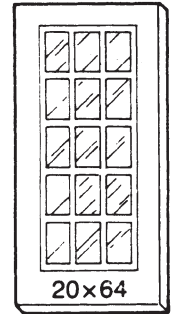

D5P

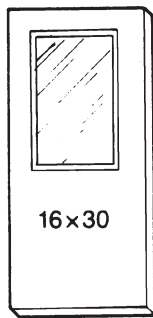

LGO ()

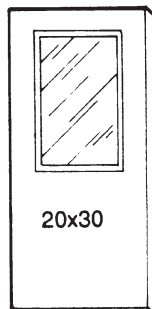

GGO ()

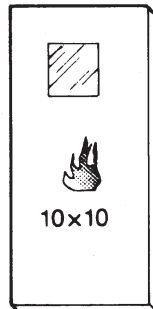

FVO () FVS

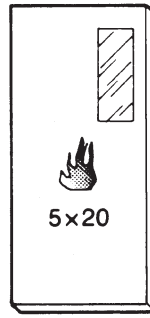

NVO ()

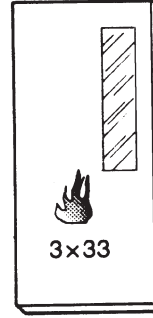

NLO ()

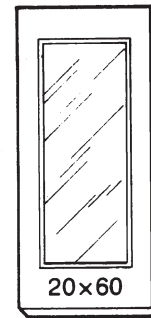

CDO ()

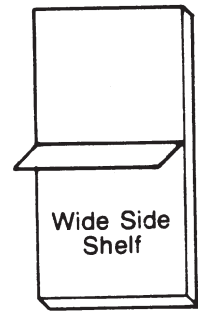

FWD

SUFFIX LEGEND (Last Letter)

F - Flush, No Light or Louver

L - Steel Louver

O - Steel Light - Open

(O)•P - with 1/4" Polished Wire Glass

(O)•S - With 1/4" Safety Glass

•WM - Wire Mesh over glass

(on opp. side of screw head of light or louver)

W - Wood Louver

S - Wood Light with 1/8" Safety Glass

D - Flush Design Variation

R - Style & Rail Design

- All wood lights and louvers are basswood

P - High Impact Polystyrene Light with Insulated Glass

IN STOCK
TO 4/0 WIDTH
TO 9/0 HEIGHT
OR
1-2 DAY EXPRESS
SHOP PRODUCTION

GENERAL NOTES

- For any other or special designs, consult office.
- All lights and Louvers are Overlap Type on Flush and Embossed Doors. Lights Vary on Wood Doors, Either Overlap or Integral.
- Steel Louvers & Lights are Labelled, Wood and Polystyrene are not.
- Lights and Louvers are so Mounted that Screw Heads are Exposed on Side Opposite Hinge Pin, or on Prehung Placed on Inside. (These are changeable in field).
- Special size Lights & Louvers are available.
- Plants are mounted on side opposite hinge pin.

FOR STANDARD HARDWARE PREPARATIONS - SEE SPECIFICATION SHEET

FRAME - STANDARD SPECIFICATIONS HARDWARE PREPS

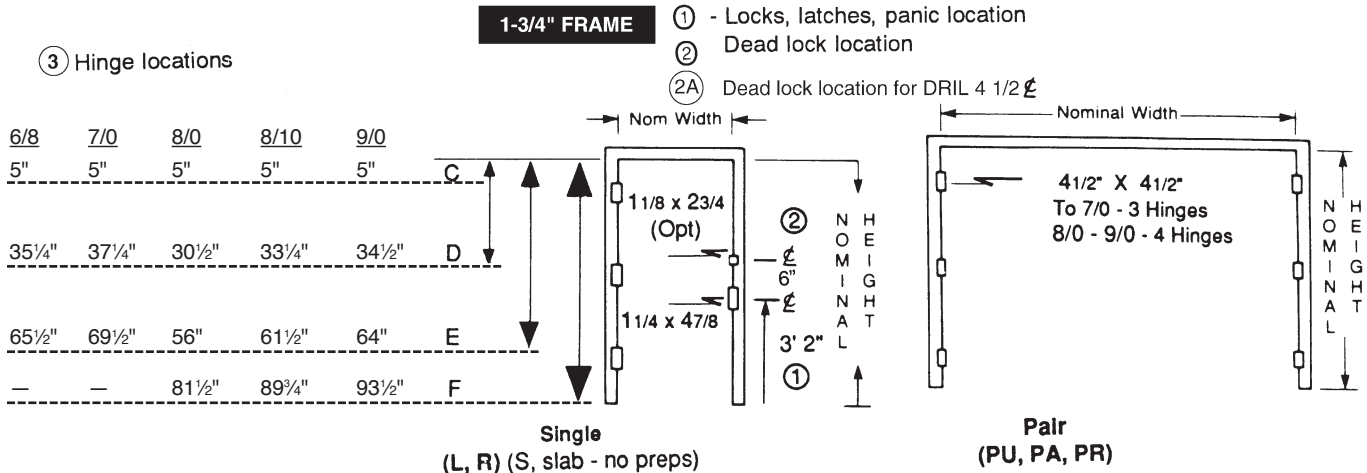

- Bottom hinge location may decrease up to 5" or less in height, if we cut down STD frame without relocation (maximum 5") strike decrease maximum = 2".
- Door opening size of frame is normally nominal width and height. Ex. 3/0x6/8=36" width head and 80" height leg.
- Information on wood frames & units not indicated.
- 5/0, 6/0 pair heads to have STD flush bolt prep

ROUGH OPENINGS

	ADD TO NOMINAL WIDTH OR HEIGHT							
	F1,2 - P		F1,2 - C		F1E		F4	
	W	H	W	H	W	H	W	H
Butt wall	4"	2"	4"	2"	5-1/4"	2"	-	-
Wrap Wall	1-3/4"	1"	3"	1"	3"	1"	1 3/4"	1"

DOOR - STANDARD SPECIFICATIONS HARDWARE PREPS

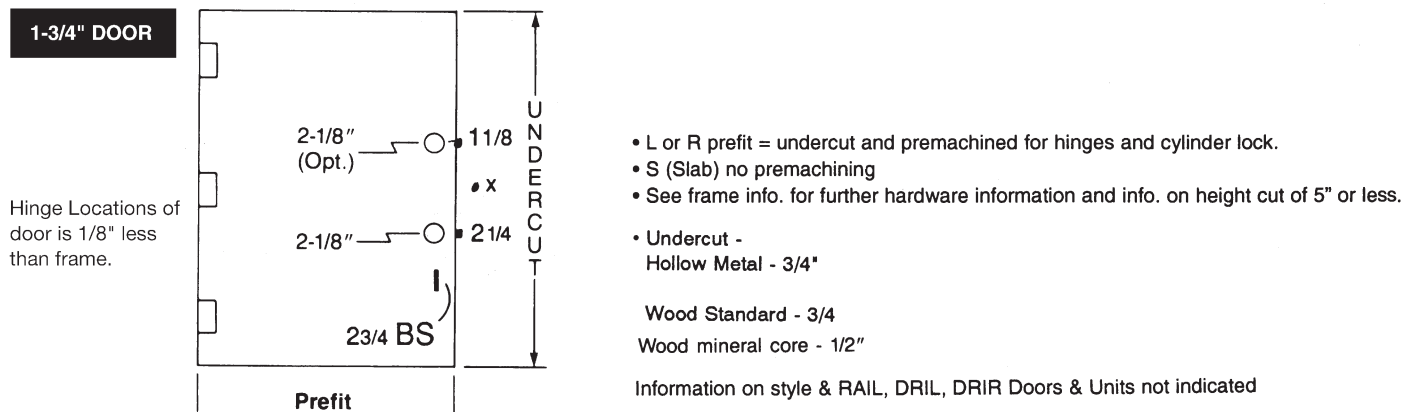

1-3/8" DOORS

1-3/8" Doors - If pre-machined for standard left or right hand

- 2-3/8" backset, 1" x 2-1/4" latch

HOLLOW METAL FRAME JAMB THROAT SIZES

DRYWALL	BLOCK OR MASONRY		IMMEDIATE AVAILABILITY JAMB THROATS
WRAP WALL	WRAP WALL	BUTT WALL	JAMB THROAT
2x3 metal stud (2 1/2) w/ 1/2" sheetrock each side	NOT APPLICABLE	YES	(3 1/2) 3 3/4 * W/ JA (1/4") OPTION JT REDUCER
2x3 metal stud (2 1/2) w/ 5/8" sheetrock each side	4" (3 5/8 BLOCK)	YES	3 3/4
2x4 metal stud (3 5/8) w/ 1/2" sheetrock each side	NOT APPLICABLE	YES	4 5/8
2x4 metal stud (3 5/8) w/ 5/8" sheetrock each side	NOT APPLICABLE	YES	4 7/8
2x4 metal stud (3 5/8) w/ double 1/2" sheetrock each side	6" (5 5/8)	YES	5 5/8
2x4 metal stud (3 5/8) w/ double 5/8" sheetrock each side	NOT APPLICABLE	YES	6 1/8
2x6 metal stud (6") w/ 5/8" sheetrock each side	NOT APPLICABLE	YES	7 1/4
-----	8" (7 5/8)	YES	7 3/4
-----	12" (11 3/4)	YES	11 3/4
*CUSTOM JAMB THROATS ARE AVAILABLE 2-3 WEEKS			*3-5 DAY AVAILABLE SPECIALS BY REDUCING JAMB THROAT W/ WELDED CHANEL *JA-REDUCE 1/4", 1 SIDE *JB-REDUCE 1/2", 2 SIDES *JC-REDUCE 1/2", 1 SIDE *JD-REDUCE 1", 2 SIDES

SPECIAL DETAIL SHEET

BILDISCO DOOR Mfg.

SALES • INSTALLATION • SERVICE

ARCHITECTURAL • INSTITUTIONAL • COMMERCIAL • APARTMENT DOOR OPENINGS

• HOLLOW METAL DOORS & FRAMES
• ALUMINUM STOREFRONTS
• ARCHITECTURAL, INSTITUTIONAL,
COMMERCIAL GRADE WOOD DOORS

21 Central Avenue
West Orange, NJ 07052
Call 973/673-2400 • Fax 973/673-2236
www.bildisco.com

• BUILDERS & CONTRACT HARDWARE
• FIREGLASS (FIP) DOORS
• APARTMENT DOORS
• LICENSED BY WARNOCK HERSEY FOR
FIRE RATED (LABELLED) OPENINGS

"The Door Doctors offer the Total Package for Immediate Delivery"

SPECIAL CUSTOM ORDERS

- SCO-F-Frame
- SCO-D-Door
- SCO-H-Hardware
- SCO-U-Unit
- SCO-M-Miscellaneous
- SCO-W-Windows

SPECIAL SHOP ORDERS

- SF-Frame
- SD-Door
- SH-Hardware
- SU-Unit
- SM-Misc

May be combination of material & include:

- STT-Template set up
- SX1-Special production hours
- SFSI - (1 man)-(2 man) Field service
- SRLA-Field labor verification

- Show all frame sizing
- Show all door sizing

00 = Exact size in inches
0/0 = Nominal size in feet/inches

All fractions = $\frac{1}{8}$
Ex. 35.1 = 35 $\frac{1}{8}$

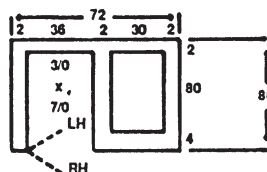

Customer _____

Job _____

Date _____

BIFOLD UNITS

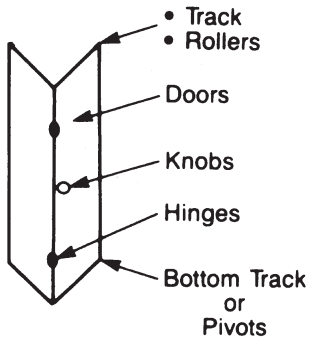

SERIES		SPECIFICATIONS			ELEVATIONS
TYPE	VENEER	THICKNESS	GRADE	DESCRIPTION	
UBDH3	• B - Birch • L - Luan	1 3/8"	3	Honeycomb core	FF
UBDH83H UBDH83B	• H Primed • B Birch	1 1/8" 1 1/8"	4 4	Honeycomb core	FF

Finished opening size - add to nominal width 0", height + 1" - If put in H.M. frame, special sizing required.

SLIDING DOOR UNITS

Top Track with Fascia

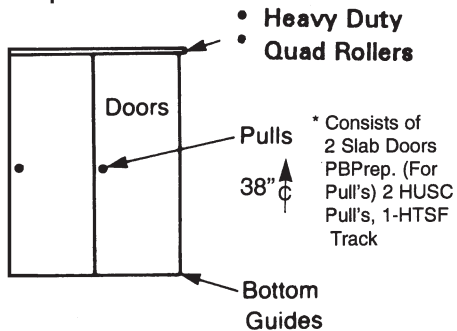

SERIES		SPECIFICATIONS			ELEVATIONS
TYPE	VENEER	THICKNESS	GRADE	DESCRIPTION	
	• B - Birch • O - Oak	1-3/4"	2 3	Solid particle core Honeycomb core	FF

OPTIONS - UR 2 3/4" undercut (resail) isatch hollow metal frame used.

Finished opening size - add to nominal width - 1", height + 2-1/4" - If put in dry wall opening. See UR option if put in frame.

ACCESS DOORS

SERIES		SPECIFICATIONS			
TYPE	FINISH	FRAME	DOOR	HARDWARE	LABEL
UCDF	P - Primed	16 GA. 3/4 Flange	14 GA. Plate	Piano Hinges	0
UEDF		16 GA. 1 Flange	20 GA. 2" Thick Insulated	Self Closing Hinges	11/2

Flush Mount for Masonry, Tile or Sheet Rock Application

ELEVATIONS

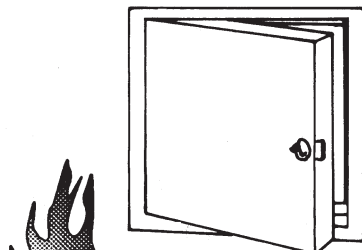

S/F
UEDF

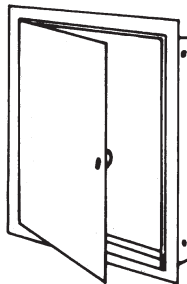

S/F
UCDF

PREHUNG WITH FRAME

ROUGH OPENINGS

Add To Nominal Width or Height

WIDTH	HEIGHT
3/8	3/8

ALUMINUM FRAMES

For Aluminum/Glass and FRP Doors (and Hollow Metal or Wood)

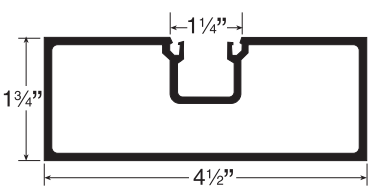
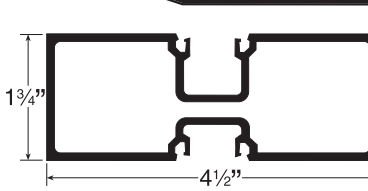
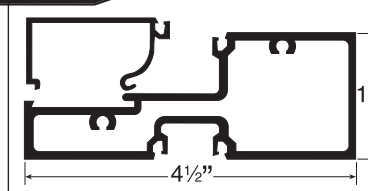
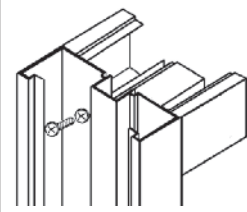
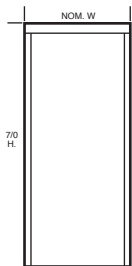
PROFILES			
			
FAP		FAM	FAS (in GB) w/Snap In CORNER (BUTT)
SERIES <ul style="list-style-type: none">FAP -FAM - } • CA - Clear AnodizedFAS - } • DB - Dark Bronze <ul style="list-style-type: none">For 1/4" GlazingDoor Opening Sections, Includes Saddle & Weatherstripping & Snap In Door Stop		JAMB THROAT WIDTH <ul style="list-style-type: none">4.4 = 4 1/2" ASSEMBLY <ul style="list-style-type: none">SA = Butt/Screwed ANCHORS <ul style="list-style-type: none">OO = None, By Installer	
 DOOR HARDWARE PREPS (See Door Specs) <ul style="list-style-type: none">PA - For Aluminum/Glass, 2 Hinges, 1 StrikePF - For F.R.P., No PrepsPH, PW - For H.M. or Wood, 3 Hinges, 1 Strike		OPTIONS & VARIATIONS <ul style="list-style-type: none">AH - Add HingeSE - Electric StrikeBP - No Strike	
Rough Opening = Nom. W + 3 3/4", Non. H. + 2"			

ELEVATIONS

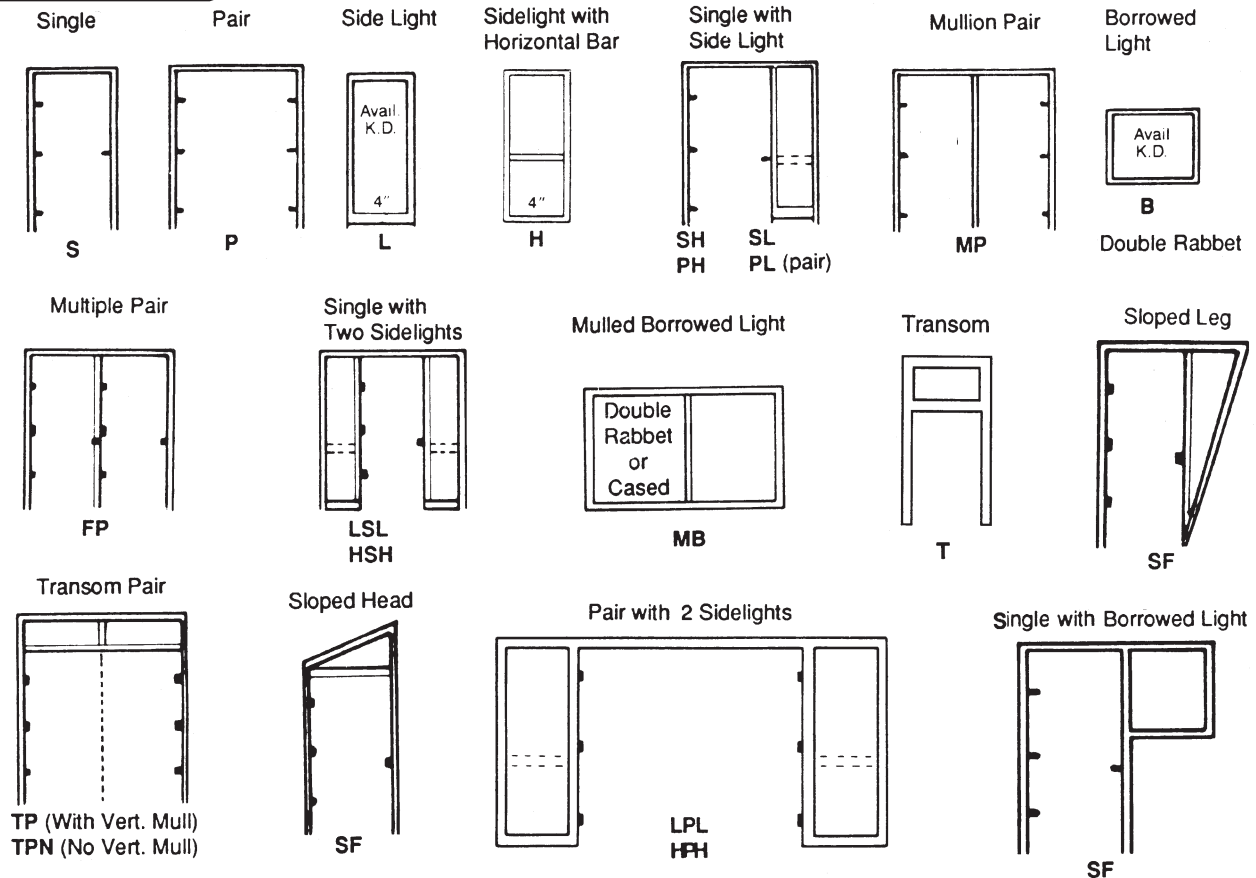

ALUMINUM/GLASS DOORS

SERIES

- DAGCA - Clear Anodized
- DAGDB - Dark Bronze
- Narrow Style - 2⁵/₁₆" Style & Top Rail, 3³/₄" Bottom Rail
- Welded Corners, Tie Rod
- Glazed with 1/4" Tempered Glass

ELEVATIONS

- DC

OPTIONS & VARIATIONS

- II - Standard Inactive Door Prep
- IA - Inactive Door Prep w/Security Astragal
- A - Active of Pair
- I - Inactive of Pair

For Frames – See Aluminum

SPECIFICATIONS

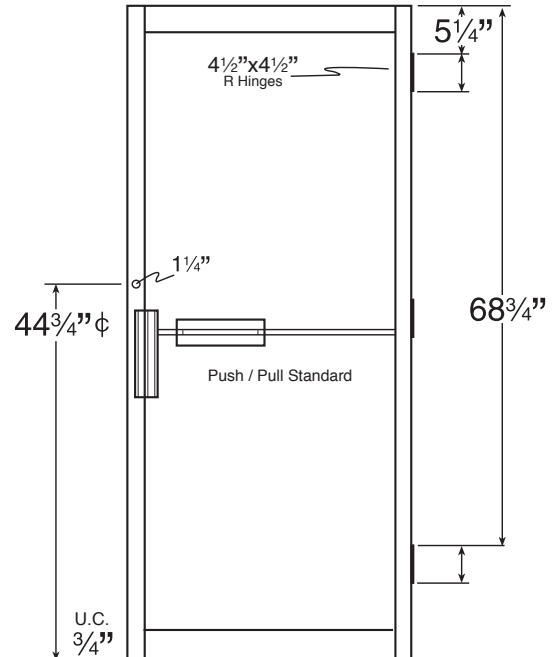

- L or R Hand
- Requires 5/8" x 3¹/₂" Frame Strike Prep

Custom Designs, Sizes, Colors Are Also Available



ALL GLASS DOORS

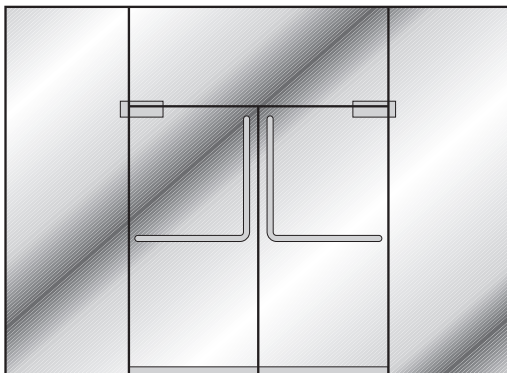

Contact
Office

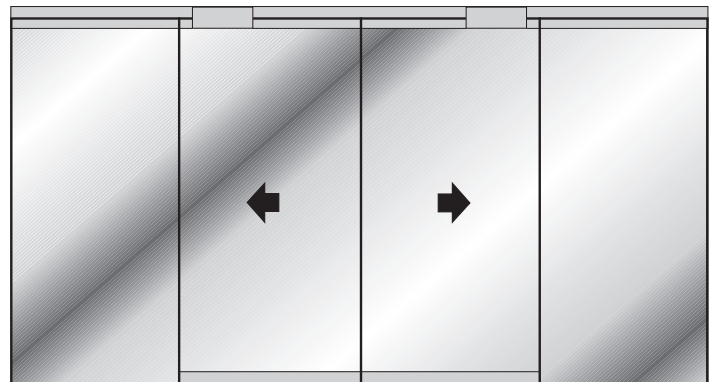

BILDISCO MFG., INC.

FRP (Fiberglass) DOORS

SERIES

	DOOR	ALUM. HINGE & LOCK EDGE
• DFRPG	Light Grey	Clear Anodized
• DFRPB	Brown	Duronodic Bronze

ELEVATIONS

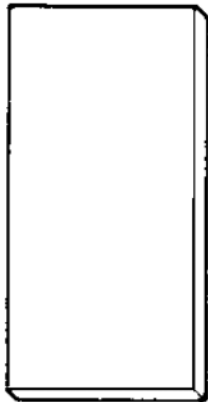

FF

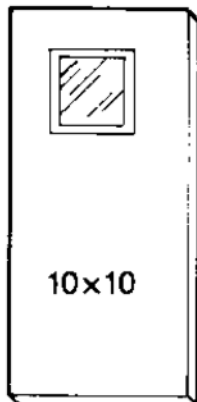

10x10

FVOG ()
FVOB ()

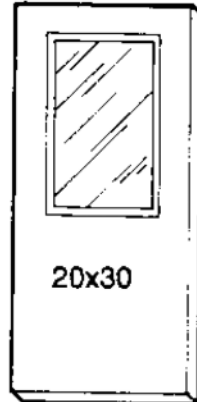

20x30

GGOG ()
GGOB ()

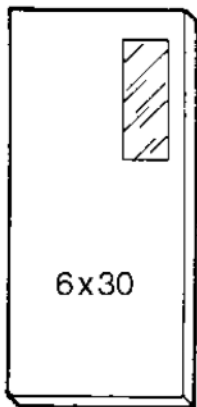

6x30

NVOG ()
NVOB ()

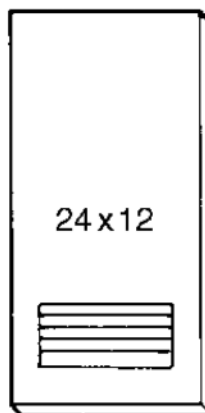

24x12

FLLG

- Extruded Aluminum w/Rubber Gasketing
- G, B To Match FRP Door
- () = Prepped for 1/4" Glazing
 - P - with Polished Wire Glass
 - S - with Safety Glass
 - T - with Tempered Glass

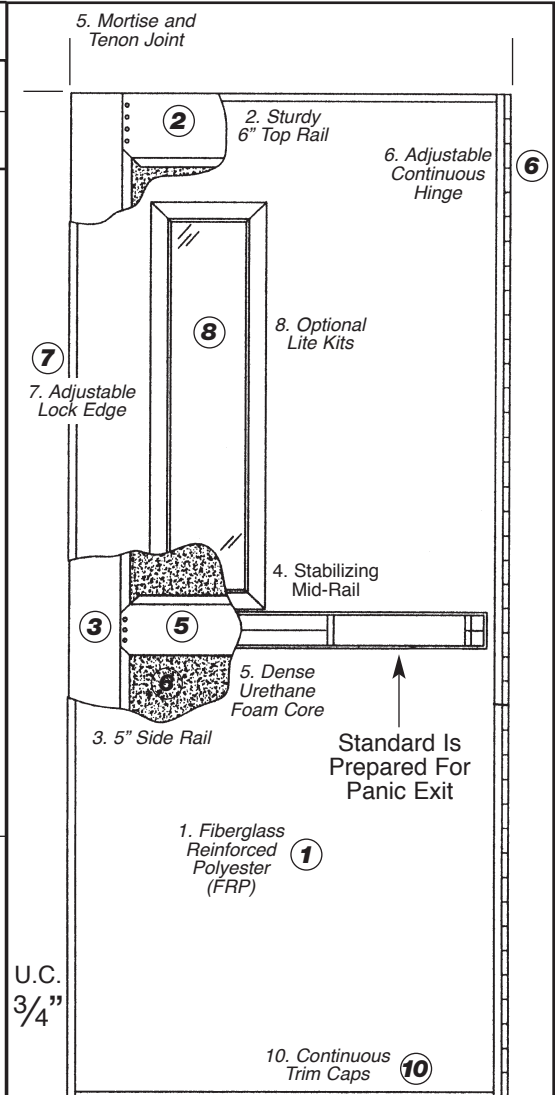

• REV = Reversible

OPTIONS & VARIATIONS

- EE - For Panic Exit & Entry
- PI - For Cylindrical Locks
- ME - For Mortise Locks
- II - Standard Inactive Door Prep (with Astragal Edge Guard)
- A - Active of Pair
- I - Inactive of Pair

FRAMES

See Aluminum or Hollow Metal

HARDWARE

FINISH LEGEND

C US26 - Bright Chrome (625)
P USP - Primed
3 US3 - Bright Brass (605)
4 US4 - Satin Brass (633)
D US26D - Satin Chromium Plated (626)
F US28 (-) - Aluminum
G US32D - Satin Stainless Steel (630)
B Black
M SBL - Silver Aluminum Lacquer (689)
R Grey or DB For Aluminum Entrance
W White
S Steel
U Brown Color
T M/F Alum

• Last letter or number of item is finish, exception misc. hdwe

OPTIONS

- Keying for Panics (HP), locks (HL), and cylinders
• **KA** - Keyed Alike, • **MK** - Master Keyed,
• **KS - KA** - Lock & Dead Lock Set,
• **GK** - Grand Master Keyed
See prefix # on above
for matching of Key
Systems (Dept. 400)

NOTES

• We will substitute on an equal basis lines on all our orders and quotes.
• All hardware shown is by indicated manufacturer or equal.
• SH Special hardware, hardware shown, not in our line
• We do not supply electronic hardware, exception electric strikes

• Parker • Schlage • Lawrence • Hager • Stanley • Bommer • Ives
• Corbin Russwin • Barrier • Pemko • Adams Rite • Detex
• LCN • Norton • Rixson • Von Duprin • Yale • Markar
& Many More, etc., etc., etc.

HL LOCKS

#	DESCRIPTION	GRADE	MANUFACTURER
HL17 __	Cylindrical Lever	1	BMIP-8161
HL5	Cylindrical Lever	1.5	BMIP-SL8160
HL __	Digital/Push Button Lever	1	ALDL2700
HL2P __	Cylindrical-Lever	2	BMIP-SL7160
HL3 __	Cylindrical-Orbit	3	BMIP-B2600
HL4 __	Tubular-Tulip	4	BMIP-9

• 2nd __ (Blank) is finish - see legend
• 1st __ (Blank) is function

FUNCTIONS

0 = entry, no core for best
1 = class, no core for best
2 = entry or office keylock
3 = storeroom, vestibule keylock
4 = classroom - keylock
5 = storeroom, no core for best
6 = privacy latch
7 = passage
8 = half dummy
D = single deadlock
2D = entry & single deadlock
9 = entry decorative handle set
B = bathroom, privacy, split finish
DD = double cylinder deadlock
DIG = digital/push button

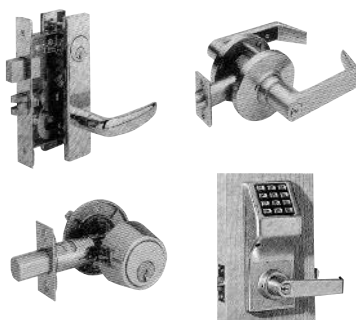

LOCK NOTES & OPTIONS

• All reversible
• All 1 3/8" or 1 3/4" doors
• All 2 1/8" face bore

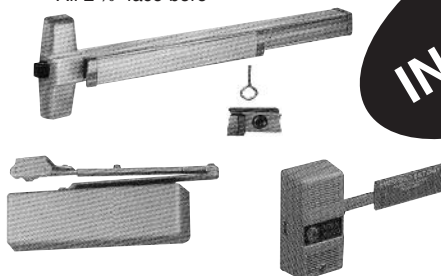

IN STOCK

LOCK SPECIFICATIONS

Grade	Backset	Strike	Latchface	Deadlock Latch Face	Deadlock Strike	Keyway Pin
G1	2 3/4	4 3/8	1 1/8 x 2 1/4	0	0	Schlage SC1 5 Pin
G1.5	2 3/4	4 3/8	1 1/8 x 2 1/4	0	0	Schlage SC1 5 Pin
G2	2 3/4	4 3/8	1 1/8 x 2 1/4			Schlage SC1 5 Pin
G3	2 3/4	4 3/8	1 1/8 x 2 1/4	1 1/8 x 2 1/4	1 1/8 x 2 1/4	Schlage SC1 5 Pin
G4	Adjustable	2 1/4	1 x 2 1/4	1 x 2 1/4	1 x 2 1/4	Kwikset 1063 5 Pin

Loose strikes and backsets are available to make locks adaptable to various frame & door conditions.

Schlage SC-1 6 pin also used in our panic trims & rim cylinders.

HC CLOSERS

#	DESCRIPTION	GRADE	MANUFACTURER
HCPM	Closer, Adj., ADA 10 year	1	PCB900AL
HCM	Closer, 10 year warranty	2	P953AL
HCFD	Door mounted hold open	2	BMIP-B135SPAC
H CPR	Closer, Adj. ADA, DB	1	PCB900DUR
HCR	Closer, UL3, Non-Handed, DB	2	P953DUR
HCLN	Closer, Xtra Heavy Duty	1	P441BCAL W/HO ARM
HCLN HO	Hold Open/Stop Arm for HCLN	1	PSTOPARM 441AL
HCCBPM	Droplate for HCPM		P607900AL
HCCBPR	Droplate for HCPR		P607900DUR
HCLNHD	Heavy Duty Arm for HCLM		HDARM441AL

HP PANIC EXIT DEVICES

HPREV	Panic exit with vertical REV	1	520VAL
HPIM	Panic exit	2	BMIP-UL523AL
HPKID	Trim-Ball with keylock	2	BMIP-KL520AL
HPKLID	Trim-lever with keylock	2	BMIP-SLL520DCH
HPKPIM	Trim-pull w/cylinder	2	BMIP-PC510AL
OHHPCP	Option cut, & recrimp vert.	-	1320DCHKD
HPVR	Top Panic Rod for 8' 1" - 10' door	1	520VRC
HP LIC	Trim, lever, no core best	1	BMIP-LL520DCHIC
HPBP	Backset, Ver. Dev. Trim	1	BMIP
HPLARD	Alarm Panic Paddle	1	AL250
HPALD	Trim Passage Lever	2 S	NLL520DCH

PANIC - Minimum door width = 2/7

HT SLIDING TRACK

Includes track and all hardware, except pulls

#	DESCRIPTION	GRADE	MANUFACTURER
HT6F	Bifold-6' with pulls	1	Hager 9570-72
HTPS	Pocket-to 8' H, 3'W	1	Hager 9629
HTSF	Sliding-6', with fascia	1	Hager 9885-72

HH HINGES

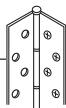

HH_	4½ x 4½ template, std	1	1279	By Hager Lawrence
HHN_	4½ x 4½ template, NRP	1	1279NRP	
HHB_	4½ x 4½ template, B.B.	1	NBB1279	
HHSP	4½ x 4½ template, spring	1	UL1278PC	
HHDAP	4½ x 4½ template, double acting	1	3029	Stanley Bommer
HHALFP	4½ x 4½ half surface, NRP	1	1138PC4HN	
HH5	5 x 5 template, BB	1	B1279	
HH34	3½ x 3½ temp., ¼" RAD.	4	1240RBP3HBQ	
HH35S4	3½ x 3½ temp., spring	3	1253HC	
HHS4P	4 x 4, temp., spring	2	1750	
HH444	4 x 4, temp., RAD.	4	1240RBP4Q	
HDRILH	4 x 4½, - For DRIL	2		
HHHSDRP	4½ x 4½ Spring for DRIL	1	Roton 780-224	
HROMF	Continuous 83" Full Mortise		Roton 780-157	
HNROTf	Continuous 83" Full Surface ¾" trim required			

IN STOCK

HU PUSH PULL

HUSOH3	Slip over entry handle	3	BMIP-2301PB	
HUH_	Push plate 3½ x 15	2	Hager-30S	
HUL_	Pull plate 3½ x 15	2	Hager-31E	
HUS_	Sliding pull, 2 x 3	1	Hager (1) CD2640	



HR PAIR OPENINGS

HRFD	Flush bolt set(2) 1 x 6¼	1	Hager-282D
HR8D	Flush bolt set extension rod	1	BMI
HRMF	Magnetic latch, s or p	1	Ives-327A92
HRSF	Surface bolt	1	BMIP 2096ZP

HB BUMPERS

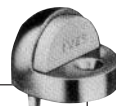

HBF_	Dome, floor, universal	1	Hager-242F
HBS_	Wall, screw in	1	Hager-236W
HBWR	Wall, self stick	1	Hager-251W

HK PLATES

HKK3	Kick 8 x 34	1	Hager 199B (US3)
HKAF	Armor, 34 x 34	1	Hager-190S
HKKF	Kick 10 x 34	1	Hager-190S (US28)
HKMF	Mop, 4 x 34	1	Hager-190S
OHNN-CP	Option, Cut plate, width		

HW WEATHERSTRIPPING, WEATHERPROOFING & SOUNDPROOFING

HWIR	Silencers, stick in	1	BMIT-240
HWB	Weatherstrip, self-stick, UL	1	Hager 726S
HWS7F	7" weatherstrip	1	Hager 896S
HWSW	Silencer, self-stick	1	BMI
HWNB7F	7" Brushed Weatherstrip Nylon	1	Hager 802SAB

HO SADDLES & THRESHOLDS

HO3T	3' alum. ½ x 5"	2	Hager 412S
HO6T	6' alum. ½ x 5"	2	Hager 412S
HO8T	8' alum ½ x 5"	2	Hager 412S

HE SWEEPS, SEALS & EXPANDERS

HE31F	Sweep - 1" x 3'	3	Hager 756S
HE4F	Sweep - 2" x 4'	2	Hager 754S
HERWU	wrap seal 3'	3	Hager 779S
HEDRILS	Sweep for DRIL	3	
HETC	Top Cap	1	Pemko 377V
HEAT	4ft. 2 1/2" Adjustable Wraparound	1	Hager 782S

HM MISCELLANEOUS HARDWARE

ANCHORS & SCREWS

HMSW3	Hinge screws, wood door, (12) 3 Fin
HME3S	3" screw f/wood - steel stud
HME5S	5" screw f/wood - steel stud
HMEAS	5" EMA dynabolt/masonry, steel
HMS.6	12-24 11/16 self drill phillips
HMS1.2	1 1/4 self drill phillips flhd
HMSMS	Hinge screws, metal dr., (24/stl)
HMML	W/loop anc./for CW, KD frame
HMSWD	Hinge screws, wood, (12), D fin
HMTBS	Thrubolts-2
HMSF34	Screw for 3 1/2 hing - FL.HP., Phillips, wood

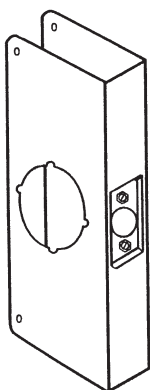
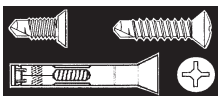

IN STOCK

EXTRA SECURITY

HMWID3	Wide Viewer, 190°, US3
HMGD3	Chain door guard, US3, brt. Brass
HMGLF	Lockguard, open out ext. dr., US28-DJPLP211 626
HMICW	Interviewer, name plt. & chime, white
HMCCR	Key cabinet/40/,grey
HMLCS	Covered 30" wind limit chain
HMAP	Padlock - std. duty
HHMDRBG	Door reinforcer - Blank - 32D
HHMDR4G	Door reinforcer - 2 3/4 BS - 32D
HMMA3D	Mail / Mag. No Sleeve US26D
HMMSL	Mail / Mag. - Sleeve
HMCHD	Coat Hook

KEYS, CORES & CYLINDERS

HMARD	Rim Cylinder for panic device
HMKEY	1 year chart kept on key system
HMKEK	Extra key
HMKME	Match existing key system
HMMBCC	Interchangeable best type core (Const.)
HMKCC	Control key for interchangeable core
HMCCMK	MK for HMBCC

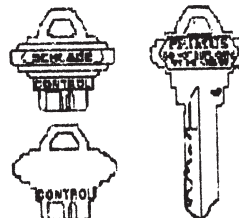

PARTS

HMCBM	Closer bracket, sbl, slv alm lac
HMTGW	Sliding trk floor guides, white
HMBS	A, miscellaneous backsets
HHMPAN	Hardware package only, for panic UL520AL3
HMBSP2	2 3/8" BS for HL2P lock 1 x 2 1/4 latch face dead latching & HL.5, Parker 1.5, 2 & 3 locks
HHBG3D	1 x 2 1/4 BS for DL-US3
HHMBG2	1 x 2 1/4 BS for Grade 2 - US3
HHMBG3	1 x 2 1/4 BS for Grade 3 - US3
HMPVC	Edge PVC Strip for DRIL Door



STRIKES

HHSD	1 1/8 x 2 3/4 strike - US26D
HHS3	1 1/8 x 2 3/4 strike - US3
HHS43	Strike, 1 1/4" x 4 7/8" US3
HHS4D	Strikes 1 1/4" x 4 7/8" US26D
HHSED	4 7/8 Elect. US26D
HHSSPM	Strike panic PR-SBL
HHSSP	High security replacement strike
OHH-DP	Option deadlock prep
OHH-SR	Option strike relocation

DOOR ACCESSORIES

WOOD MOULDING, ASTRAGALS & VENEER

MW80	8 ft. oak astragal, $\frac{5}{16}$ x 1 $\frac{3}{4}$
MW8P	8 ft. pine astragal, $\frac{5}{8}$ x 1 $\frac{3}{4}$
MWLB	Mld., wood lights, beech per lft.
MWS7B	Stiles, doors, for 7' birch
MWV88	Veneer - 4' x 8', birch
MWV80	Veneer - 4' x 8', oak
MWVB	Veneer - 3' x 7', birch
MWVO	Veneer - 3' x 7', oak

FILLERS

MMFF2S	Strike 2 $\frac{3}{4}$ ", for frame, steel
MMFF4S	Strike 4.7, for frame, steel
MMFF8S	Mortise edge, for doors, steel
MMFFCS	Cylinder face bore, f/door, stl
MMFFHS	Hinge 4.4", for door/frame, stl
MMFFIS	Inactive edge plate f/door, stl
MMFFLS	Latch edge plate, for door, stl
MMFFPS	Pressure fit hole, for frame, st
MMFFRS	Reversing swing, for door, stl
MMFFSS	Hinge shims, 4.4. door/frame
MMFMTC	Converts mort edge to cyl edge
MMFLPA	Latch prep adaptor (to 1-1/8")

IN STOCK

GLASS

METAL, MOULDINGS, ASTRAGALS & ANGLES

MS1AP	Mold 10', $\frac{1}{2}$ x 1", primed steel
MS2AP	Mold 10', $\frac{1}{2}$ x 2", primed steel
MS3AP	Mold 10', 2" x 2", primed steel
MS4AP	Mold 10', $\frac{1}{2}$ x 4", primed steel
MS5AP	Mold 10', 4" x 4", primed steel
MS6AP	Mold 7'2", $\frac{3}{8}$ x $\frac{1}{2}$ P
MS7P	7 ft. metal astragal - flat
MS8P	8 ft. metal astragal - flat
MSGBP	Glazing bead per lft., .5 x 1" w/screw
MSLP	Lft. - mold special, Mtl lights
MMSEG	Blank, Edge Guard 8/0 (2)

See doors, frames, units detail sheets for any glass installed (glazed) in doors or frames

MMP	$\frac{1}{4}$ " wire glass - per sq ft
MMS	$\frac{1}{4}$ " safety glass - per sq ft
MMT	$\frac{1}{4}$ " tempered glass - per sq ft
MMTGLAS	$\frac{1}{4}$ " tempered glass - installed
MMGG	Size / Prep / Glazed
OMMX-GG	See MMGG
MMGO	Size / Prep / Loose - See Note
OMMX-GO	See MMGO
MMGA	Glaze Aluminum (per panel)

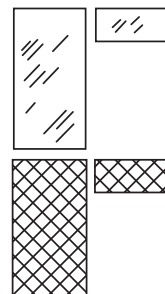

PAINT & PRIMER

MMBEN	Dur bronze enamel-aer can910B
MMGAP	Galvacon, glvzg zinc prmr, USP
MMGOL	Gold brs lacq, arsl can/3/, gbl
MMSLD	Slvr almn lac, arsl cn/26D,32D/

MATCHING PANELS

Usually for transoms or sidelights

MM_	Panel per sg pr - see note for size
MMPAN	Sized, prepped & installed in frame
LB	Labelled birch
LM	Labelled metal
LO	Labelled oak
MB	Matching birch
MM	Matching metal
MO	Matching oak

IN THE FIELD

We can install, service or repair all your door opening requirements.

IN OUR SHOPS

We can repair even more effectively as well as customize your new or present openings to your specific needs. For example we can preinstall all hardware in door & frames.

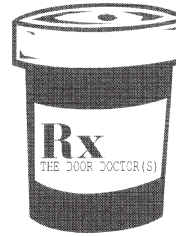

We have the Rx to make your sick doors well.

PRICING

- All prices are hourly, parts and supplies billed separately
- Hourly charge includes - direct labor (Shop & Field), fringes, insurance, supervision & coordination, cleanup, material distributed from on site storage, overhead & amortization of equipment utilized
- All supplies and parts used (left on job or used in openings) this includes but is not limited to; bits, blades, discs, fillers, paint, caulking, reinforcements, rods, screws etc. will be billed separately.
- All hourly rates are charged to the next 1/2 hour increments
- Travel time - field service - charged hourly, one hour min
- All notes and work to be done & any parts & supplies used to be put on special detail sheet & work sheet, which will then activate billing after work is completed.

FIELD SERVICE, REPAIR, INSTALLATION

- SFSI-1 - Hourly charge 1 man
- SFSI-2 - Hourly charge 2 men
- SRLA - Verification of rated opening for application of label. Warnock Hershey or Underwriters Lab - hourly
- Parts & Supplies ? (as needed)
- SFOV - Field Service - Outside Vendor - Job Price

IN STOCK**SHOP REPAIR, CUSTOMIZE, PREINSTALL HARDWARE**

- SSRW - Pickup, handling and redelivery of customers material
- SSTT - Special template for production - One time charge
- SSXI - Special production, repair customize, preinstall hardware in doors, frames - hourly
- Parts and Supplies? (as Needed)

NOTES

- See door schedule for material, terms & important notes. All material must be tagged.
- Refuse & Debris - removal & disposal by customer.
- Customer to have precleared any union or prevailing wage requirements.
- There must be a secured area for equipment & material storage.
- There must be on site during work an approver - I.E. an individual who is authorized to sign off & approve, review & approve any extras in advance, approve shop work done, make & sign checks for COD if necessary, etc., etc.