

BILDISCO DOOR Mfg.

• ARCHITECTURAL • INSTITUTIONAL • COMMERCIAL • APARTMENT-DOOR OPENINGS

*Hollow Metal
Doors &
Frames*

*Aluminum
Doors & Frames
(Including Storefronts)*

*Architectural,
Institutional,
Commercial Grade
Wood Doors*

*Builders &
Contract
Hardware*

*FRP
(Fiberglass)
Doors*

*Apartment
Doors*



*Licensed by Warnock
Hershey for labeling
(fire rating) openings*

Sales

Installation

Service

"The Door Doctors offer the Total Package for Immediate Delivery"

EVERY DAY LOW PRICES

- Every day low consistent unit prices means every day is a sale day
- Buying Direct - Saves you 40-60%
- You buy material when you need it
- Prices are consistently low - 24 hours a day, 7 days a week
- Printed price list available for your convenience

WHEN YOU BUY FROM "THE SOURCE", YOU SAVE MONEY, \$\$\$

INSTALLATION, SERVICE & REPAIR

IN THE FIELD

We can install, service or repair all your door opening requirements.

IN OUR SHOPS

We can repair even more effectively as well as customize your new or present openings to your specific needs. For example we can preinstall all hardware in door & frames.

We can build it, service it, repair it, at your house or ours.
THE WAY YOU WANT IT!!

SERVICES OFFERED (Partial List) ON Any Manufacture Of:
WOOD - HOLLOW METAL - STEEL /
DOORS - FRAMES - MILLWORK - HARDWARE

WE DO:

- REPLACEMENT
- REPAIRING
- RETROFITTING
- RENOVATION
- FIXING
- RELOCATION
- REMODELING
- PROBLEM SOLVING
- ADJUSTING
- REMOVAL
- ALTERATIONS
- RIPOUT
- REINSTALLATION
- INSTALLATION

OF:

-
- PUNCH LIST PROBLEMS**
- SECURITY UPGRADE
 - IMPROPERLY OPERATING DOORS
 - REKEYING OF LOCKS
 - LOCK UPGRADE
 - FIRE RATING RETROFIT
 - PANIC DEVICE UPGRADE
 - IMPROPERLY CLOSING DOORS
 - ELECTRICAL HARDWARE
 - FRAMES NOT PLUMB
 - HINGE RELOCATION
 - GLAZING UPGRADE
 - EMERGENCY DOOR SERVICE
 - HARDWARE RELOCATION

OF

- ENERGY UPGRADE
 - JOB CLEAN UP
 - HARDWARE PREPARATION
 - PROBLEM DOOR OPENINGS
 - CLOSER INSTALLATION
 - DOOR BINDING PROBLEM
 - IMPROPERLY OPERATING HARDWARE
 - DOORS NOT LATCHING
 - SECURITY GLASS & WIRE
 - BUILDING CODE COMPLIANCE
 - (EX.) • AMERICANS WITH DISABILITIES ACT
 - EGRESS RETROFIT
 - SMOKE & CORRIDOR RETROFIT
 - LOCKSMITH SERVICE
- etc., etc., etc., etc., etc., etc., etc., etc., etc.,
 etc., etc., etc., etc., etc., etc., etc., etc., etc.,

etc., etc., etc., etc., etc., etc., etc., etc., etc., etc.,
etc., etc., etc., etc., etc., etc., etc., etc., etc., etc.

GUARANTEED QUALITY

- All products are guaranteed and are so indicated along with material grades in our catalog
- Our product standards were developed by our affiliation with:
 - AWI - Architectural Woodwork Institute
 - NAAMM - Nat. Assoc. of Arch. Metal Mfg.
 - NWDDA - Nat. Wood Windows & Doors Assn.
 - SDI - Steel Door Institute
 - DHI - Door & Hardware Institute
- All of whom are the best and most widely respected source for specifications in the Door, Frame and Hardware Industry.
- We Manufacture and fabricate 90% of our material in our own shops for complete quality control
- We are approved & licensed by Warnock Hershey for labeling (fire rating) of our products
- A.D.A. Approved

FRAMES

**Hollow
Metal &
Aluminum**

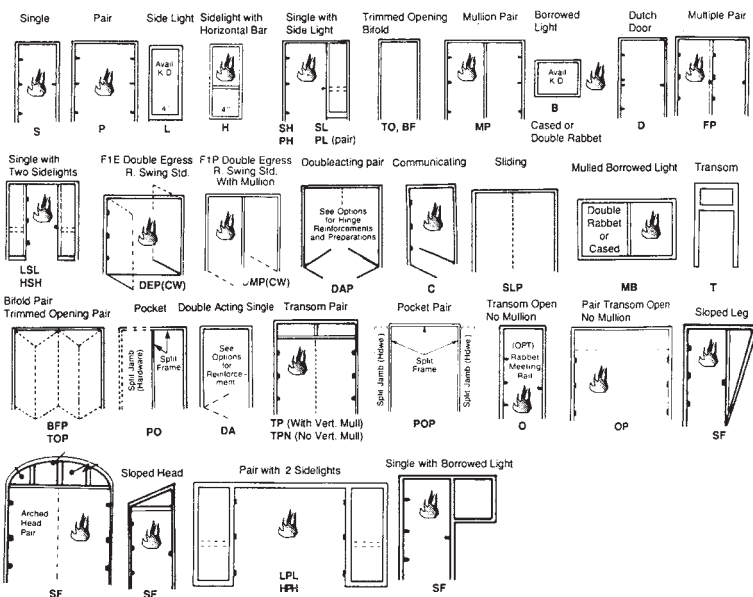

FRP

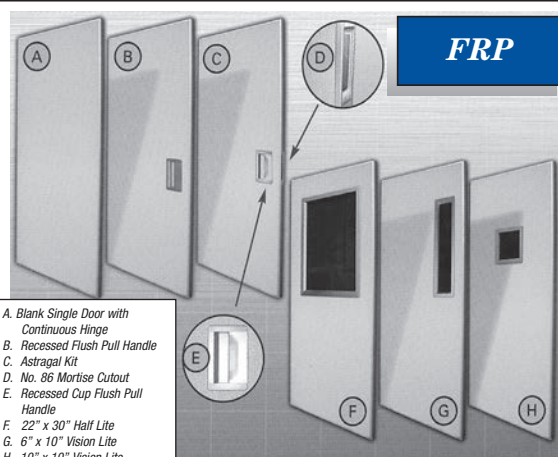

- A. Blank Single Door with Continuous Hinge
- B. Recessed Flush Pull Handle
- C. Astragal Kit
- D. No. 86 Mortise Cutout
- E. Recessed Cup Flush Pull Handle
- F. 22" x 30" Half Lite
- G. 6" x 10" Vision Lite
- H. 10" x 10" Vision Lite
- I. HG-105 Continuous Aluminum Pin and Barrel Hinge Guard
- J. HG-305 Continuous Stainless Steel Pin and Barrel Hinge Guard

All FRP Solution Doors are supplied with an adjustable continuous hinge.

ARCHITECTURAL WOOD & METAL DOORS

- Any design you want in style & Rail or Flush type doors
- Any face you want in Metal, Birch, Oak, Luan, Walnut, Mahogany, Cherry, Poplar, Fir, Pine etc. etc.



PLASTIC LAMINATED DOORS

Wood Doors laminated with Formica or
Wilson - Art (2 sides or 4 sides)

Low Maintenance

Doors surfaced with plastic laminate are built to withstand heavy day-to-day wear of high traffic areas. Locations such as hallways, lobbies, classrooms, auditoriums and offices demand the durability. Our doors are guaranteed never to need refinishing. The only 'tools' needed to preserve their beauty, over the lifetime of a building, are soap and water.

HARDWARE

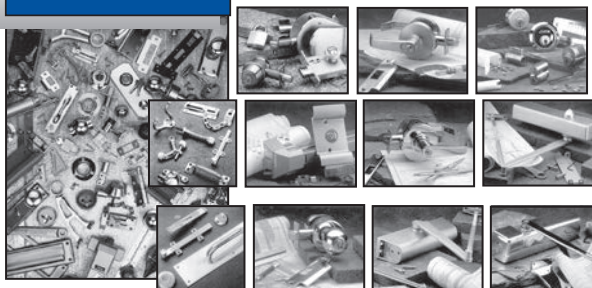

- LOCKS
- CLOSERS
- PANIC EXIT DEVICES
- SLIDING TRACK
- HINGES
- PUSH/PULLS
- PAIR OPENINGS
- BUMBERS
- PLATES
- ANCHORS & SCREWS
- EXTRA SECURITY
- STRIKES
- WEATHER STRIPPING,
WEATHER PROOFING
& SOUND PROOFING
- SADDLES & THRESHOLDS
- SWEEPS, SEALS
& EXPANDERS
- KEYS, CORES & CYLINDERS

**PREFINISHED (OR
PRIMED) WOOD DOORS**

SAVE FIELD LABOR, TIME AND \$\$\$

- We can Prefinish any wood doors in our shops (3-5 day availability) using either a two coat or 3 coat clear spray process
- We can also Prime in our shops using a one coat spray process
- Stain prefinishing of both standard and custom finishes also available

FOR IMMEDIATE DELIVERY

- Over \$3,000,000 worth of Doors, Frames, Hardware, Glazing & Millwork - IN STOCK •
- High Tech, State of the Art Custom Shop Production - 1 to 5 Days
- On Time Delivery In Our Own Trucks or Same Day Pick Up •

THE FEDERAL EXPRESS OF THE DOOR, FRAME & HARDWARE BUSINESS

DOORS

Hollow Metal
Wood • Aluminum
FRP • Glass

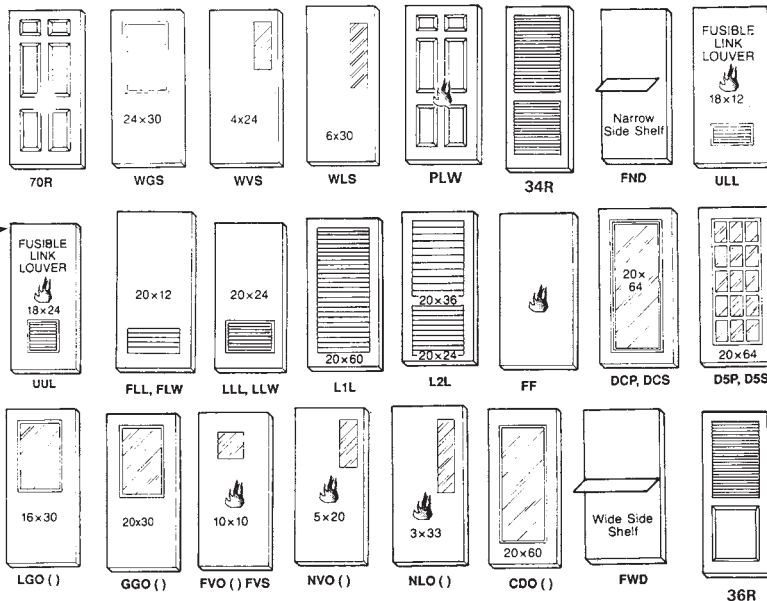

HUGE SELECTION

- Specialists in Door Openings - Huge Inventory and Selection.
- Unbelievable depth & breadth of inventory - \$3,000,000 inventory in our 75,000 sq. ft. plant
- High-tech state of the art production facilities for 1-5 day production
- Doors, frames, Hardware, Glazing & Millwork From - Steel, Wood, Metal, Glass Hardwoods which we manufacture, fabricate, distribute & service
- For the - industrial, public, commercial & residential sector
- Used in - renovation, replacement, new construction, tenant fit up and remodeling
- Available immediately - doors & frames to 4/0 wide & 9/0 high

IF IT OPENS & CLOSSES & PEOPLE WALK THROUGH IT, WE CAN SUPPLY IT!

ALUMINUM ENTRANCES (STORE FRONTS)

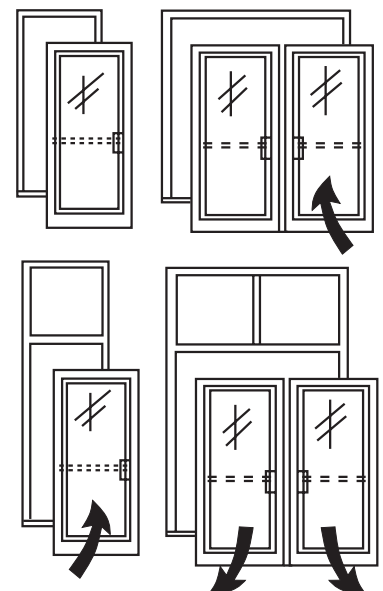

BIFOLD UNITS

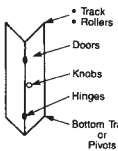

SERIES		SPECIFICATIONS		ELEVATIONS
TYPE	VENEER	THICKNESS	GRADE	DESCRIPTION
UBD-H3	• B - Birch • L - Luan	1 3/8"	3	Honeycomb core
UBD-H3H	• H - Primed • B - Birch	1 1/8"	4	Honeycomb core
UBD-H3H3	• H - Primed • B - Birch	1 1/8"	4	Honeycomb core

Finished opening size - add to nominal width 0", height - 1" - If put in H.M. frame, special sizing required.

STAINLESS STEEL DOORS & FRAMES



Nothing surpasses the performance of Stainless Steel when the effects of a corrosive atmosphere must be dealt with - or a highly sanitary environment must be maintained.

- Chemical Plants • Swimming Pools
- Sewage Treatment Plants • Laboratories
- Research Facilities • Marine Installations
- Hospitals • Food and Meat Processing Plants
- Series HS can be provided with "B" Label
- Type 304 Stainless, with a #4 finish is standard.
- Type 316 Stainless, with a #4 finish is also available.

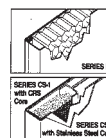

SOUND INSULATING METAL OR WOOD DOOR & FRAME ASSEMBLIES

When sound control between connected spaces is essential, specify BMI Sound Insulating Assemblies for:

- Executive Offices, Conference Rooms and Board Rooms • Screening Rooms • Psychiatric Clinics • Libraries
- Broadcast Studios • Rehearsal Rooms • Test Cell Control Rooms • Theater Lobbies • In-Plant Enclosures and other sound sensitive areas.

BMI Sound Insulating Assemblies are furnished as a complete Frame and Door unit, with Perimeter Gasketing and Drop Seal. Acoustical laboratory test reports available on request.

Model No.	F35	F39	F40	F42	F45	F49	F52
Elevation	FLUSH*	FLUSH*	FLUSH*	FLUSH*	FLUSH*	FLUSH*	FLUSH*
STC Rating	35	39	40	42	45	49	52
UL Label	3 HR	3 HR	1 1/2 HR	1 1/2 HR	3 HR	3 HR	3 HR

*Glass Lite available for some models - consult BMI. Wood assemblies also available. STC ratings other than 35.

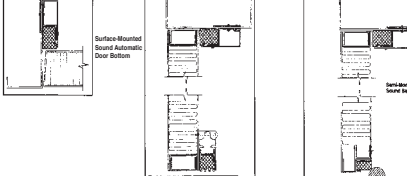

LEAD LINED WOOD OR METAL DOORS & FRAMES



• Lead is either 1/32", 1/16", or 1/8"

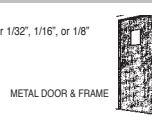

SLIDING DOOR UNITS

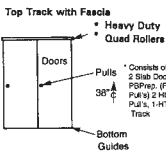

SERIES		SPECIFICATIONS		ELEVATIONS
TYPE	VENEER	THICKNESS	GRADE	DESCRIPTION
SD-H3	• B - Birch • O - Oak	1 3/4"	2	Solid particle core
SD-H3H	• H - Primed • B - Birch	1 3/4"	3	Honeycomb core

Options: - UR - 2 3/4" undercut (transit) if and, hollow metal frame used.

Finished opening size - add to nominal width - 1", height - 2 3/4" - If put in dry wall opening. See UR option if put in frame.

ACCESS DOORS

SERIES		SPECIFICATIONS		ELEVATIONS	
TYPE	FINISH	FRAME	DOOR	HARDWARE	LABEL
UCDF	P - Primed	18 GA. 3/4 Flange	14 GA. Plate	Plano Hinges	0
UEDF		16 GA. 1 Flange	20 GA. 2" Thick Insulated	Self Closing Hinges	11/2

Flush Mount for Masonry, Tile or Sheet Rock Application

PREHUNG WITH FRAME

ROUGH OPENINGS

Add To Nominal Width or Height

WIDTH 3/8 HEIGHT 3/8

S/F UEDF

S/F UCDF

FREE PROFESSIONAL SERVICES

- Professional and courteous staff of both field representatives and customer service personnel to serve you
- FREE catalog with information you need
- FREE fax-quote service
- FREE charge service
- FREE field evaluation measurements and layout
- FREE delivery, on time, in our own trucks
- FREE plans & specs takeoff service
- And more than FREE - we pay you a 5% rebate if you pick-up & a 5% rebate if you pay upon receipt.

WE STILL OPERATE THE OLD FASHIONED WAY, PROFESSIONALLY, COURTEOUSLY & FREE!

FOR IMMEDIATE DELIVERY

- Over \$3,000,000 worth of Doors, Frames, Hardware, Glazing & Millwork - IN STOCK •
- High Tech, State of the Art Custom Shop Production - 1 to 5 Days
- On Time Delivery In Our Own Trucks or Same Day Pick Up •

THE FEDERAL EXPRESS OF THE DOOR, FRAME & HARDWARE BUSINESS



Bildisco offers the *TOTAL PACKAGE*
SALES — INSTALLATION — SERVICE — FOR IMMEDIATE DELIVERY

BILDISCO DOOR Mfg.

SALES • INSTALLATION • SERVICE

ARCHITECTURAL • INSTITUTIONAL • COMMERCIAL • APARTMENT DOOR OPENINGS

- HOLLOW METAL DOORS & FRAMES
- ALUMINUM STOREFRONTS
- ARCHITECTURAL, INSTITUTIONAL, COMMERCIAL GRADE WOOD DOORS

21 Central Avenue
 West Orange, NJ 07052
 Call 973/673-2400 • Fax 973/673-2236
www.bildisco.com

- BUILDERS & CONTRACT HARDWARE
- FIBERGLASS (FRP) DOORS
- APARTMENT DOORS
- LICENSED BY WARNOCK HERSEY FOR FIRE RATED (LABELLED) OPENINGS

"The Door Doctors offer the Total Package for Immediate Delivery"

Phone 973-673-2400
Fax 973-673-2236
www.bildisco.com